



NICK CHAMPION

PROPERTY | AUCTIONS | AGRICULTURE | PROFESSIONAL

34 GODSONS CLOSE

TENBURY WELLS, WORCESTERSHIRE, WR15 8HY

TO LET UNFURNISHED ON AN
ASSURED SHORTHOLD TENANCY

RENT £550 PCM + FEES

EXCLUSIVE & PAYABLE IN ADVANCE



**A MID-TERRACED HOUSE IN A POPULAR RESIDENTIAL AREA
WITHIN WALKING DISTANCE OF THE TOWN CENTRE.**

- KITCHEN/DINER • SITTING ROOM • TWO BEDROOMS • BATHROOM
- SOUTH FACING GARDEN • DRIVEWAY PARKING SPACE • EPC RATING D

NICK CHAMPION LTD

16 Teme Street, Tenbury Wells, Worcestershire, WR15 8BA

Tel: 01584 810555 | Fax: 01584 810888

www.nickchampion.co.uk



34 GODSONS CLOSE, TENBURY WELLS, WORCESTERSHIRE, WR15 8HY

ACCOMMODATION

A canopy porch with a part glazed door leads into the sitting room with a laminate wood floor and electric fire with decorative painted wood surround. The kitchen/diner has a range of cream base and wall units incorporating a stainless steel sink/drain, an integral Lamona electric oven and Lamona electric hob, space for a fridge/freezer, plumbing for a washing machine, and a partially glazed door to outside.

Stairs from the sitting room rise up to the first floor landing with an airing cupboard housing the Glow worm 30 hxi boiler and hot water cylinder. There are two bedrooms with laminate wood flooring and the bathroom has a bath with shower over, a pedestal basin and wc.

OUTSIDE

A tarmac driveway provides parking space for one car. The south facing rear garden has a patio, gravel paths between shrub and flower borders, and can be accessed externally via a shared footpath to the west of No 32.

SERVICES

Mains water, drainage, gas and electricity are connected.
Gas fired central heating.
UPVC framed double glazing.

FIXTURES & FITTINGS

All items in the nature of fixtures and fittings not mentioned within these particulars or the inventory are excluded.

LOCAL AUTHORITY

Malvern Hills District Council - Tel: 01684 862151
Council Tax Band B

ENERGY PERFORMANCE CERTIFICATE

EPC Rating D - Full details available upon request or follow the link:

<https://find-energy-certificate.digital.communities.gov.uk/energy-certificate/0366-2862-7915-9691-2461>

TENANCY

For a minimum period of six months on an Assured Shorthold Tenancy.

TENANT FEES

See attached Tenant Fees Schedule for information.

SECURITY DEPOSIT

A refundable security deposit of £630 is required at the commencement of the tenancy to be held in the Tenancy Deposit Protection Scheme (Custodial) provided by the Deposit Protection Service. The deposit is returned at the end of the tenancy subject to the terms having been satisfactorily met and subject to any dilapidations.

SPECIAL TERMS

The Tenant to keep the property and garden in a reasonable and tenantable order and must not make any alterations, sublet or redecorate without prior consent from the Landlord.

- NO SMOKERS AND NO PETS

VIEWING

By prior appointment with the Agent: -
Nick Champion – Tel: 01584 810555

View all of our properties for sale and to let at: -
www.nickchampion.co.uk

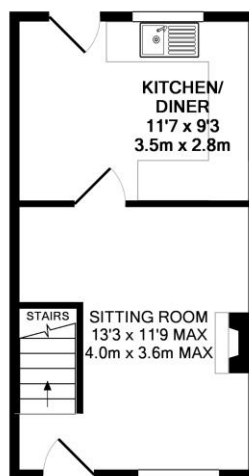

GROUND FLOOR

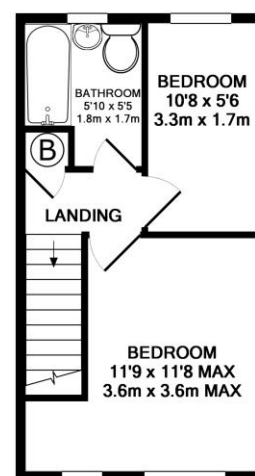

FIRST FLOOR

Whilst every attempt has been made to ensure the accuracy of the floor plan contained here, measurements of doors, windows, rooms and any other items are approximate and no responsibility is taken for any error, omission, or mis-statement. This plan is for illustrative purposes only and should be used as such by any prospective purchaser. The services, systems and appliances shown have not been tested and no guarantee as to their operability or efficiency can be given.
Made with Metropix ©2019

Photographs taken: 18th March 2021

Particulars prepared: March 2021

N218 Printed by Ravensworth 01670 713330

These particulars have been prepared in good faith to provide a general overview of the subject property and not a statement of fact. Any photograph(s) may portray only parts of the subject property at the time they were taken and may no longer be an accurate representation. Prospective purchasers should make their own enquiries as to the structural condition of the property and the nature and condition of any services, appliances, equipment or facilities that may be included in the sale. All areas, measurements, aspects and distances referred to within the particulars are merely provided as a guide and are approximate, and prospective purchasers must rely on their own enquiries.

These particulars are provided on the understanding that all negotiations are conducted through Nick Champion. Neither these particulars nor oral representations form part of any offer or contract and their accuracy cannot be guaranteed. Prospective purchasers are strongly advised to obtain verification of all matters pertaining to the sale of the subject property from their own solicitor or surveyor.

TENANT FEES SCHEDULE

NEW ASSURED SHORTHOLD TENANCIES (ASTs) SIGNED ON OR AFTER 1 JUNE 2019

Holding Deposit (per tenancy)

One week's rent. This is to reserve a property. Please Note: This will be withheld if any relevant person (including any guarantor(s)) withdraw from the tenancy, fail a Right-to-Rent check, provide materially significant false or misleading information, or fail to sign their tenancy agreement (and / or Deed of Guarantee) within 15 calendar days (or other Deadline for Agreement as mutually agreed in writing).

Security Deposit (per tenancy. Rent under £50,000 per year)

Five weeks' rent.
This covers damages or defaults on the part of the tenant during the tenancy.

Security Deposit (per tenancy. Rent of £50,000 or over per year)

Six weeks' rent.
This covers damages or defaults on the part of the tenant during the tenancy.

Unpaid Rent

Interest at 3% above the Bank of England Base Rate from Rent Due Date until paid in order to pursue non-payment of rent. Please Note: This will not be levied until the rent is more than 14 days in arrears.

Lost Key(s) or other Security Device(s)

Tenants are liable to the actual cost of replacing any lost key(s) or other security device(s). If the loss results in locks needing to be changed, the actual costs of a locksmith, new lock and replacement keys for the tenant, landlord any other persons requiring keys will be charged to the tenant. If extra costs are incurred there will be a charge of £15 per hour (inc. VAT) for the time taken replacing lost key(s) or other security device(s).

Variation of Contract (Tenant's Request)

£50 (inc. VAT) per agreed variation. To cover the costs associated with taking landlord's instructions as well as the preparation and execution of new legal documents.

Change of Sharer (Tenant's Request)

£50 (inc. VAT) per replacement tenant or any reasonable costs incurred if higher.
To cover the costs associated with taking landlord's instructions, new tenant referencing and Right-to-Rent checks, deposit registration as well as the preparation and execution of new legal documents.

Early Termination (Tenant's Request)

Should the tenant wish to leave their contract early, they shall be liable to the landlord's costs in re-letting the property as well as all rent due under the tenancy until the start date of the replacement tenancy. These costs will be no more than the maximum amount of rent outstanding on the tenancy.

Please ask a member of staff if you have any questions about our fees.

CLIENT MONEY PROTECTION:
www.propertymark.co.uk

INDEPENDENT REDRESS:

propertymark